

TECHNICAL DATA

FROM

Anemostat

Door Products

4958 Stout Dr. #119, San Antonio, TX 78219
 PH: 210.662.6300 • FAX: 210.662.2828

e-mail: door@anemostat.com • website: www.anemostat.com

SG-10-SP-SSD

HIGH SECURITY
 METAL VISION FRAME WITH
 SPEAK PORT AND
 SECURITY SLIDING DOOR

NOT FIRE RATED

DETAIL DRAWING

NOTE: Door slides from side to side.
 Non-centered vision frame
 cutout is generally required.

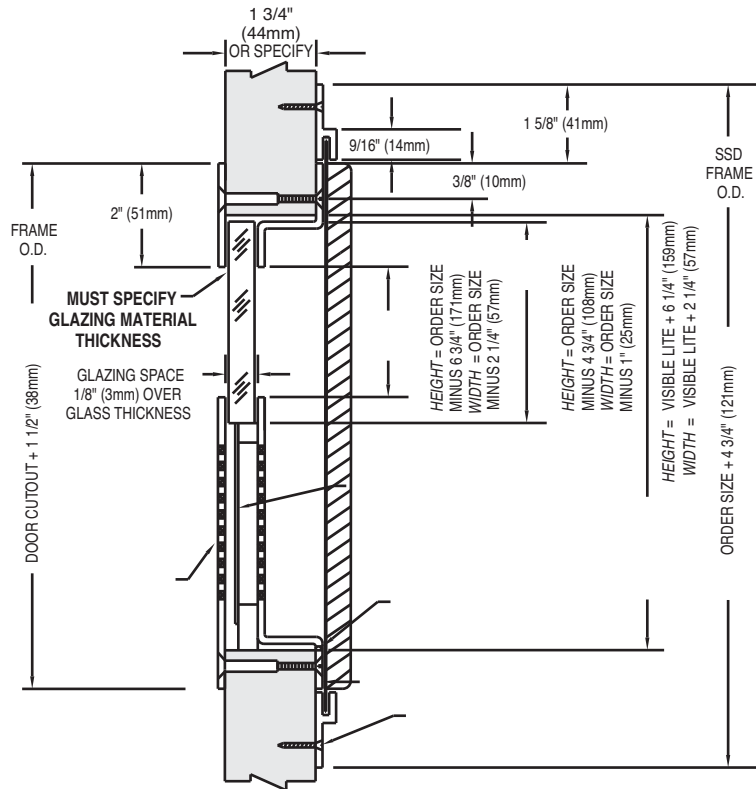
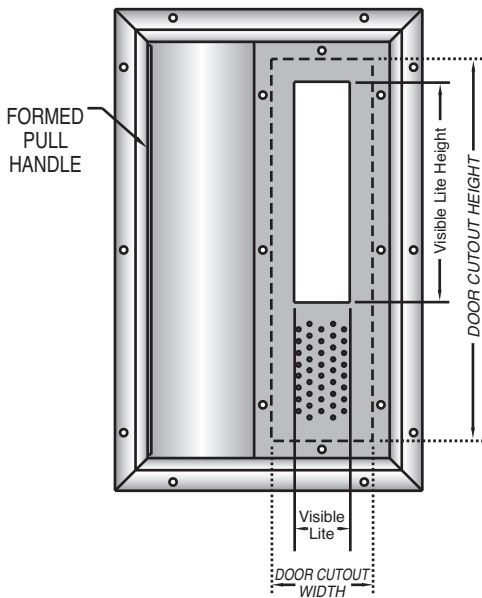

NOTE: Width O.D. DIMENSION of SSD portion will be double the width of actual Door Order / Cutout size plus 6-1/4". Height O.D. DIMENSION will be actual Door Order / Cut-out size plus 4-3/4". Please consider your door width when ordering.
EXAMPLE: 12"X12" Order/Cut-out size= 30-1/4"(12"+12"+6-1/4")x16-3/4"(12"+4-3/4")
RECOMMENDATION: Do Not make cutouts in door prior to receiving SSD products.

STANDARD PRODUCT FEATURES

- MATERIAL:**
SG-10 is: 10 GA. (3.4mm) C.R.S. Frame on glass 3/16" (5mm) to 1" (25mm) thick.
 12 GA. (2.5mm) C.R.S. Frame on glass over 1" (25mm) to 1 9/16" (40mm) thick.
SSD is: 12 GA. (2.5mm) C.R.S. Frame and Sliding Door.
SPEAK PORT: Two 10 GA. (3.4mm) C.R.S. plates with perforated faces with 5/32" (4mm) diameter holes on 7/32" (5.6mm) staggered centers.
- FINISH:** Grey Primer, Beige or Bronzed Baked Enamel
- INSTALLATION:** By drilling 1/4" (6mm) holes thru the door around the perimeter of the door cutout. Vision Frame has countersunk mounting holes for #8x32 one way vandal proof security screw thru bolts with a blank head on one side for a flush appearance, and improved security. Sliding door frame fits over vision frame, and installs with #8 x 3/4" one way vandal proof security screws.
- DOOR THICKNESS:** For 1 3/4" (44mm) (std), or up to 2 1/4" (57mm) (specify)
- GLAZING:** Thickness can range from 3/16" (5mm) and up to 1 9/16" (40mm). Glazing space of 1/8" (3mm) over glass thickness is standard, allowing for glazing tape to be used on both sides of the glazing material.

OPTIONAL FEATURES

- MATERIAL:** #304 or #316 Stainless Steel, #4 Finish (Satin), Galvanized (Zinc Plated).
- FINISH:** Custom Baked Enamel Colors (as per sample chip supplied)
- FASTENERS:** Special Security Screw Fasteners. See page 26, this section.
- SPECIALS:** Fractional sizes and other steel gauges (contact factory).

FIRE RATINGS

- SG-10-SP-SSD is not fire rated.**
- NOTE:** For exterior use, High Humidity or Salt Air application, product must be Galvanized or Stainless Steel.
- IMPORTANT:** Interpretation of building and fire codes may vary. Consult with the local authority having jurisdiction in your area, to determine appropriate standards.

Job Name & Location	Submitted by